

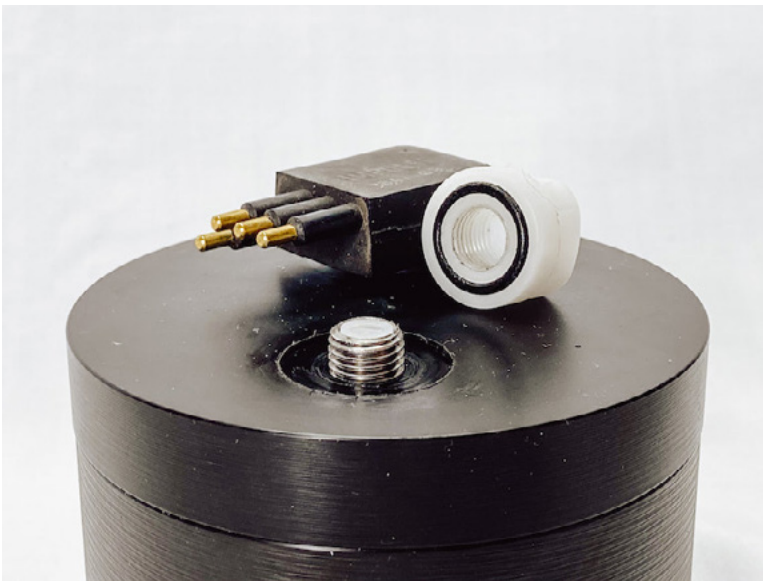

Purge Port for Endcaps

PP-129



Our patented self-sealing Purge Port for End Caps are used with the Global Ocean Design Deck Purge Box to remove moisture and perform a vacuum leak test.

Once the Purge System Connector is removed, a check valve inside the Purge Port closes, sealing the partial vacuum inside the housing, providing time to carefully clean, inspect, and lightly grease the Pressure Proof Cap (PP-103), the o-ring and end cap surface prior to final assembly.

This self-sealing Purge Port (PP-129) fits a 7/16-20 tapped hole and spotface in an endcap. Large UNF threads reduce possible damage from cross threading and over-torquing.

Key Features:

- Self-sealing check valve
- Small footprint
- Pressure Proof Caps available to match most housing materials
- Easy to install; installation notes included
- Patented design

Notes:

- Requires a Pressure Proof Cap (PP-103) (sold separately) customer to specify material to match end cap
- Requires a Deck Purge Box (DPB-107), or a Purge System Connector (PP-127)

[globaloceandesign.com](https://www.globaloceandesign.com)

info@globaloceandesign.com

858.560.1799

7955 Silverton Ave., Suite 1208
San Diego, CA 92126

Purge Port for Endcap

PP-129

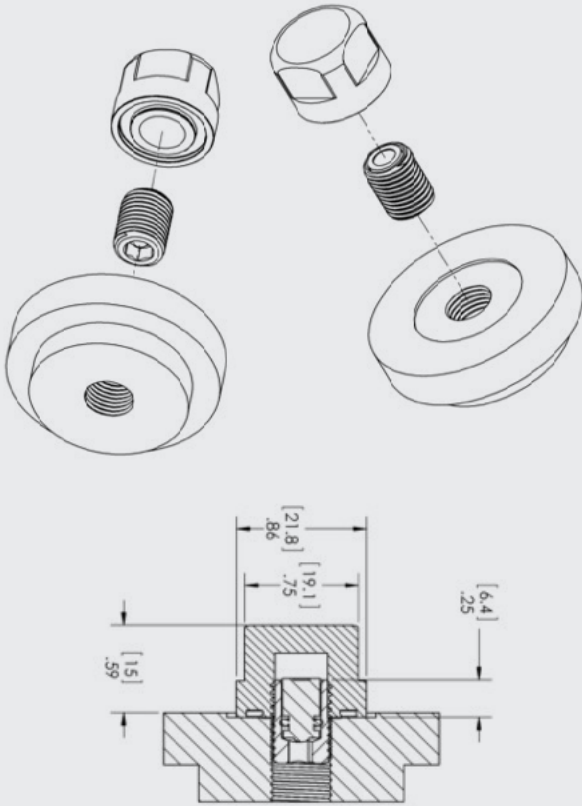

Specifications:

- Requires 7/16-20 x 3/8" full thread tapped hole in housing, tap drill through, with 1" spotface (32 RMS Circular finish).
- Pressure Proof Cap (PP-103) available in Ti 6-4, 6061-T6, 316SS, or Delrin to match end cap material (sold separately).
- For aluminum Pressure Proof Caps, it is recommend that the tapped hole in the end cap **not** be anodized so that the Pressure Proof Cap is electrically connected to the end cap for corrosion protection.
- Used with Global Ocean Design Deck Purge Box (DPB-107).

Companion Product:



Deck Purge Box

DPB-107

The patented Deck Purge Box dynamically removes moisture vapor from undersea housings and provides a vacuum leak test to check seal integrity.